

# C5e PATCH PANEL UTP 50u

單位:mm

產品編號 : 17200

產品品名 : 3A-EPLEM-121BKZ

台製 3ANET 模組式 1U 10吋 12 Ports

C5e Patch Panel 網路跳線面板 跳接面板 黑色

## Performance:

Meets C5e EIA/TIA 568B Standard.

## Materials:

Front Plate : Fireproof ABS UL-94V0  
Panel : Metal (SPCC)  
Jack : 8P8C 50 micro inches gold plated  
PCB : FR-4 / UL-94V0  
IDC Cap : Fireproof ABS UL-94V0  
IDC Body : Fireproof ABS UL-94V0  
IDC Pin : Bronze & Tinned

IDC Description : For 22-26 AWG.

For 110 punch-down Tool

## Electrical Specifications:

Insulation Resistance : 500M ohms (min.)  
Contact Resistance : 20m ohms (max.)  
Current Rating : 1.5 Amps .  
DC Resistance : 0.1 ohms (max.)  
Withstanding Voltage : 1000 VAC RMS @ 60Hz / 1 min.

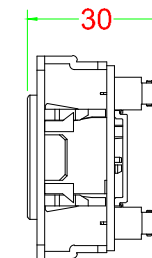
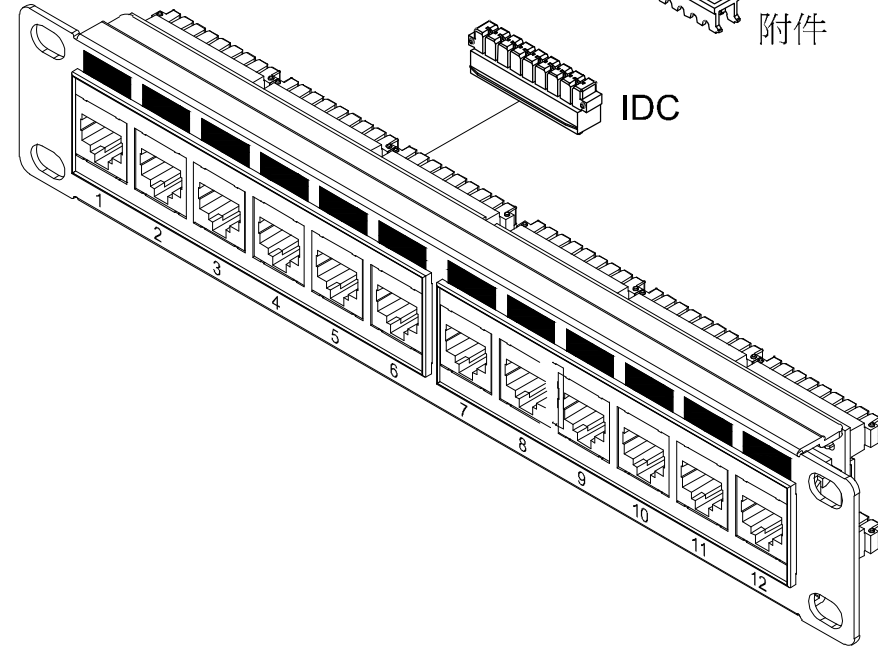
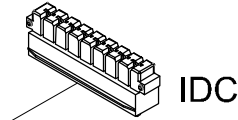
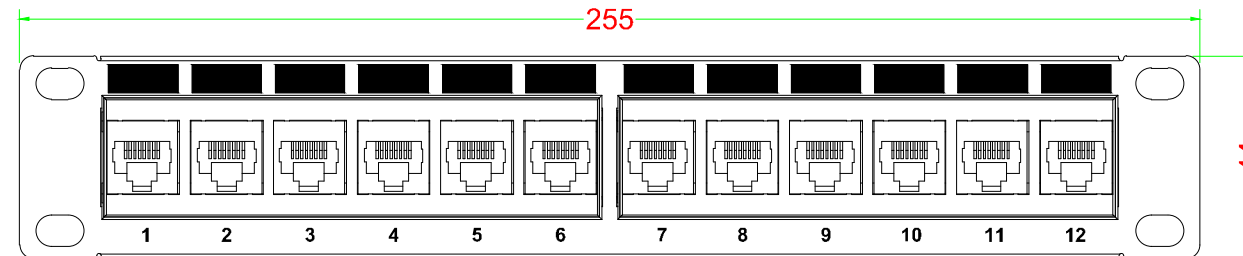

## Mechanical Specifications:

IDC Punch Down Cycle : Over 250 Cycles (min.)  
Jack Insertion Cycle : Over 2000 Cycles (min.)

Operation Temperature : -40 °C ~ +70 °C